

农机具配件

SPARE PARTS FOR IMPLEMENTS

圆盘耙片
Harrow discs

深松铲
Subsoiler blades

犁体部件
Ploughbody parts



农业机械零配件

SPARE PARTS & ACCESSORIES FOR AGRICULTURAL MACHINE

圆盘耙片/DISCS

标准材料/STANDARD MATERIAL

- 原材料 / RAW MATERIAL: **30MNB5**
- 化学成分 / LIMIT OF THE CHEMICAL COMPOSITION

%C: 0,28/0,32
%MN 1,10/1,30
%SI 0,15/0,35
%P 0,030
%S 0,030
%CR 0,20/0,50
%AL 0020/0050
%TI 0030/0050
%B 00015/40

- 热处理 / THERMAL TREATMENT: 淬火
- 洛氏硬度 / HARDNESS: **48/50 HRC ROCKWELL**

优势:

- 高耐磨性
- 高厚度镀铬硬化层

BENEFITS:

- HIGHER WEAR RESISTANCE
- DUE TO THE CHROME, GREATER DEPTH OF HARDENING

要求材料/REQUIRED MATERIAL

- 原材料 / RAW MATERIAL: **34MNCRB5**
- 化学成分 / LIMIT OF THE CHEMICAL COMPOSITION

%C: 0,34/0,38
%MN 1,20/1,40
%SI 0,15/0,30
%P 0,020
%S 0,010
%CR 0,100/0,200
%AL 0020
%TI 0020/0050
%B 00015/40

- 热处理 / THERMAL TREATMENT: 淬火
- 洛氏硬度 / HARDNESS: **48/52 HRC ROCKWELL**

刃口热轧/CUTTING EDGE HOT ROLLING

所有圆盘耙片都是热轧片。热轧的过程就是对圆盘耙片进行感应加热，并通过合适的生产设备进行轧制。这一过程可保证纤维的密实度，刃口的最大强度和耐磨性。这一点是与普通刃口压型工艺最基本的区别。

All disks are hot-rolled. Hot rolling is a process by which the disk is heated by induction and rolled with the proper equipment. This process allows compactness of the fibers, giving the most cutting edge strength and wear resistance and this is the substantial difference from cutting edge profiling

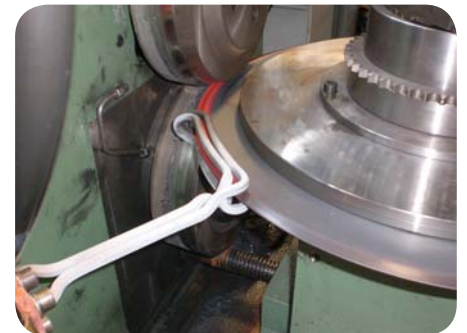

圆盘耙片的强度、韧性和平面性测试: TEST OF STRENGTH, FLEXIBILITY, AND PLANARITY OF DISCS :



15T



所有测试完成后，圆盘耙片仍然可以与垂直平面完美贴合。
After these tests, the disc is placed on a vertical flat surface to show its perfect planarity.

耙片 - 雷肯 625 MM
DISC LEMKEN MODEL 625 MM

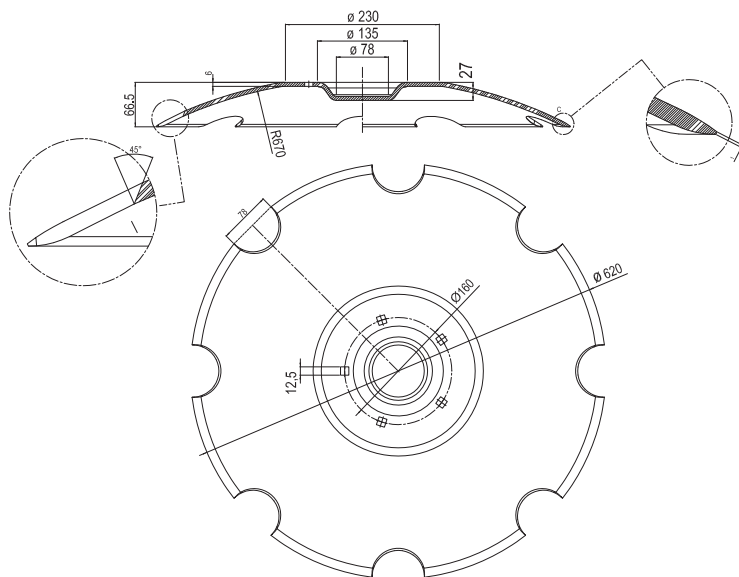

可根据客户要求定制不同直径和孔径的产品。
FOR HIGH VOLUMES, WE ARE AVAILABLE TO PRODUCE DISCS WITH CUSTOMIZED DIAMETER AND HOLES.

埃马编号 Cod. AMA	NAF编号 Cod. NAF	直径 Ø	厚度 Thickness mm	中心孔径 Hole diameter mm	凹度 Concavity mm	说明notes	原厂号 Orig. ref.
CP6210	DUN111	625 mm	6 mm	88	60,5 mm	5个方形连接孔，边长12.5mm，孔距160mm N° 5 square holes 12,6mm, distance between holes 160mm	3490467

耙片 - 雷肯索力特 5826028
DISC LEMKEN-SOLITAR 5826028 MODEL

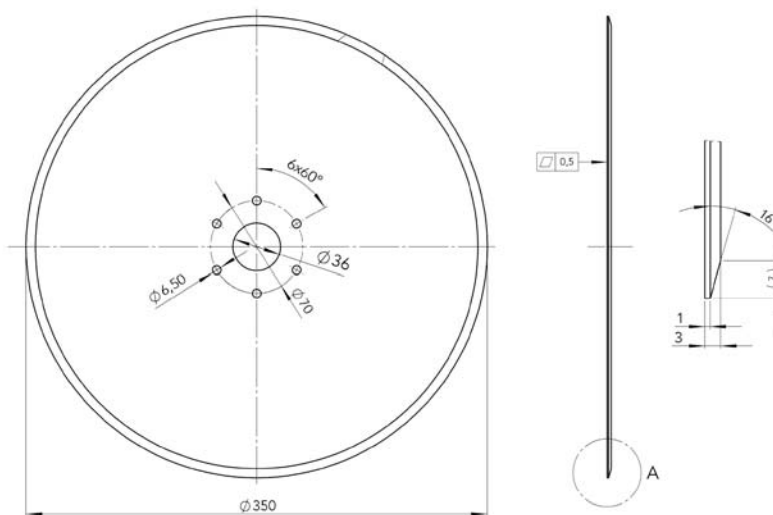

可根据客户要求定制不同直径和孔径的产品。
FOR HIGH VOLUMES, WE ARE AVAILABLE TO PRODUCE DISCS WITH CUSTOMIZED DIAMETER AND HOLES.

埃马编号 Cod. AMA	NAF编号 Cod. NAF	直径 Ø	厚度 Thickness mm	中心孔径 Hole diameter mm	说明notes
CP6200	D350LT36F6S3	350 mm	3 mm	36	6个圆形连接孔，直径6.5mm，孔距70mm N° 6 holes 6,5mm, distance between holes 70mm

圆盘耙片/DISCS

圆盘-格兰

KVERNELAND DISC

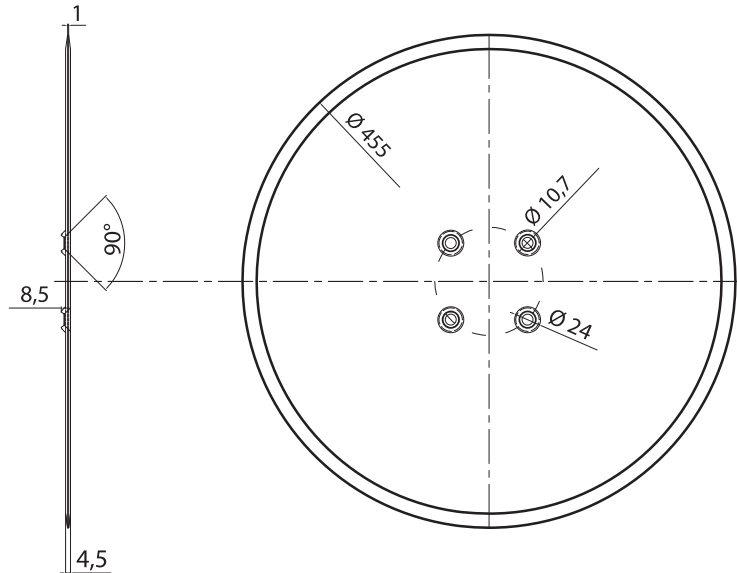
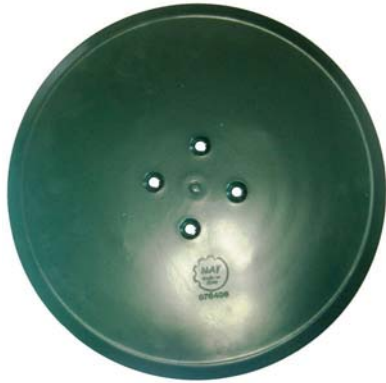

可根据客户要求定制不同直径和孔径的产品。

FOR HIGH VOLUMES, WE ARE AVAILABLE TO PRODUCE DISCS WITH CUSTOMIZED DIAMETER AND HOLES.

埃马编号 Cod. AMA	NAF编号 Cod. NAF	直径 Ø	厚度 Thickness mm	中心孔径 Hole diameter mm	凹度 Concavity mm	说明notes	原厂号 Orig. ref.
RC1852	DKVN02	455 mm	4.5 mm	/	平面 SMOOTHED	4个圆形连接孔，直径10.7mm N° 4 pressed holes 10,7mm	076406

波纹圆盘

WAVED DISC

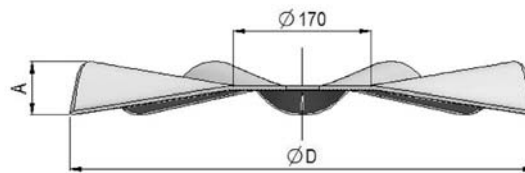
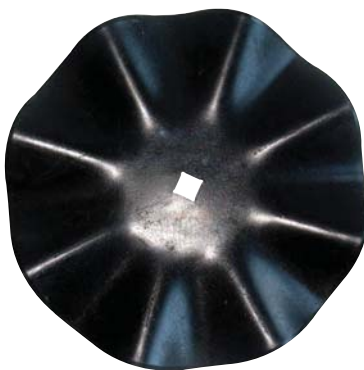

可根据客户要求定制不同直径和孔径的产品。

FOR HIGH VOLUMES, WE ARE AVAILABLE TO PRODUCE DISCS WITH CUSTOMIZED DIAMETER AND HOLES.

直径 Diameter mm	凹度 Concavity mm	平面直径 Disc flat
470	51	170 mm.
520	60	170 mm.
580	66	170 mm.

轮轴总成（配焊接式法兰盘）
COMPLETE HUB SET FOR INDIPENDENT DISC HARROW (WITH WELDED FLANGE)

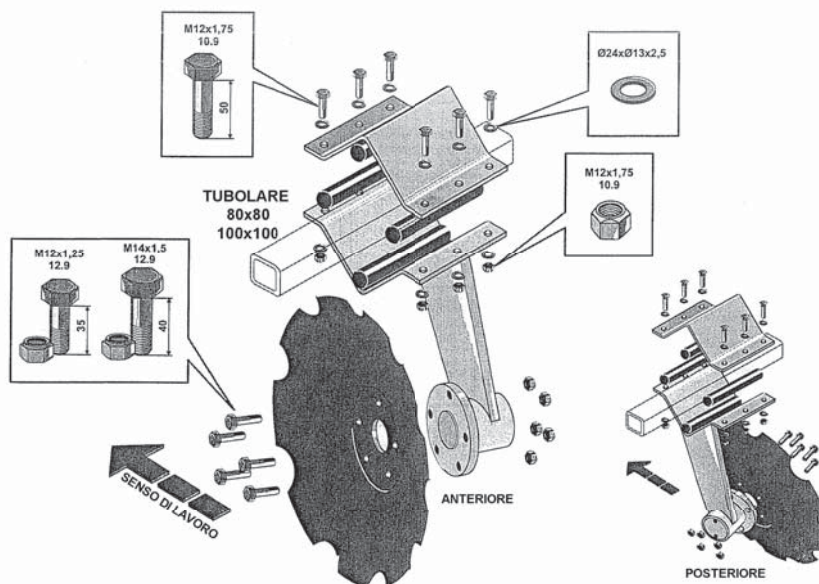

编号 Ref.	说明 Notes
CP5851/CP5853	配直径460mm的缺口耙片
CP5855/CP5857	配直径510mm的缺口耙片
CP5859/CP5861	配直径560mm的缺口耙片
CP5863/CP5865	配直径610mm的缺口耙片

说明：图中所注螺母、螺栓仅用于本产品总成适配体系的说明，并不作为配件提供。
Notes: NUTS/ BOLTS AND TUBULAR IN FIGURE ARE ONLY TO ILLUSTRATE THE FITTING SYSTEM OF THE COMPLETE SUPPORT AND THEY ARE NOT SUPPLIED AS SPERE PARTS.

轮轴总成（配拆卸式法兰盘）
COMPLETE HUB SET FOR INDIPENDENT DISC HARROW (WITH REMOVABLE FLANGE)

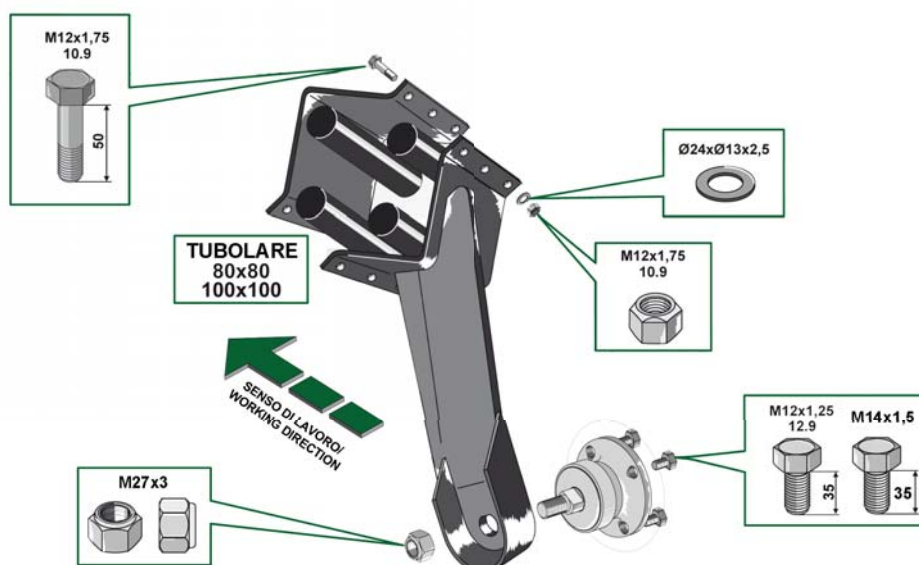

编号 Ref.	说明 Notes
CP6341/CP6342	配直径460mm的缺口耙片
CP6343/CP6344	配直径510mm的缺口耙片
CP6345/CP6346	配直径560mm的缺口耙片
CP6347/CP6348	配直径610mm的缺口耙片

说明：图中所注螺母、螺栓仅用于本产品总成适配体系的说明，并不作为配件提供。
Notes: NUTS/ BOLTS AND TUBULAR IN FIGURE ARE ONLY TO ILLUSTRATE THE FITTING SYSTEM OF THE COMPLETE SUPPORT AND THEY ARE NOT SUPPLIED AS SPERE PARTS.

深松铲/SUBSOILER BLADES

深松铲特性:

- 适于日常高强度工作
- 铲体整体经淬火硬化处理
- 高度耐用
- 翻转式铲尖, 经淬火硬化处理

配置我司深松铲的深松机, 更有助于庄稼的生长。

体现在:

- 便于土壤深松作业
- 促进根系生长
- 利于灌溉
- 耕作过程中不破坏土壤

Subsoiler blade:

- Strong for daily use
- Hardened quality
- Strong handle
- Reversible, tempered tips

With our subsoiler blade, you can help your crops growth.

The curved tines allow:

- cracking of the fields pan
- aid in root growth

- rapid drainage of water

The blades don't disrupt the soil and leave a level finish.

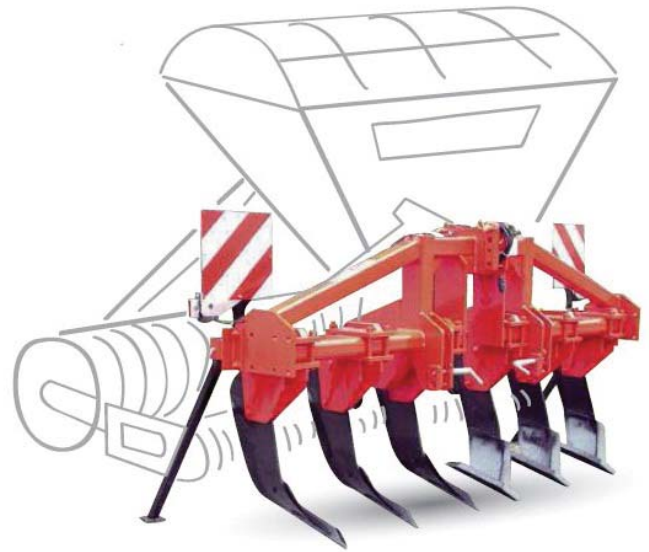

大型深松铲
CURVED TINE

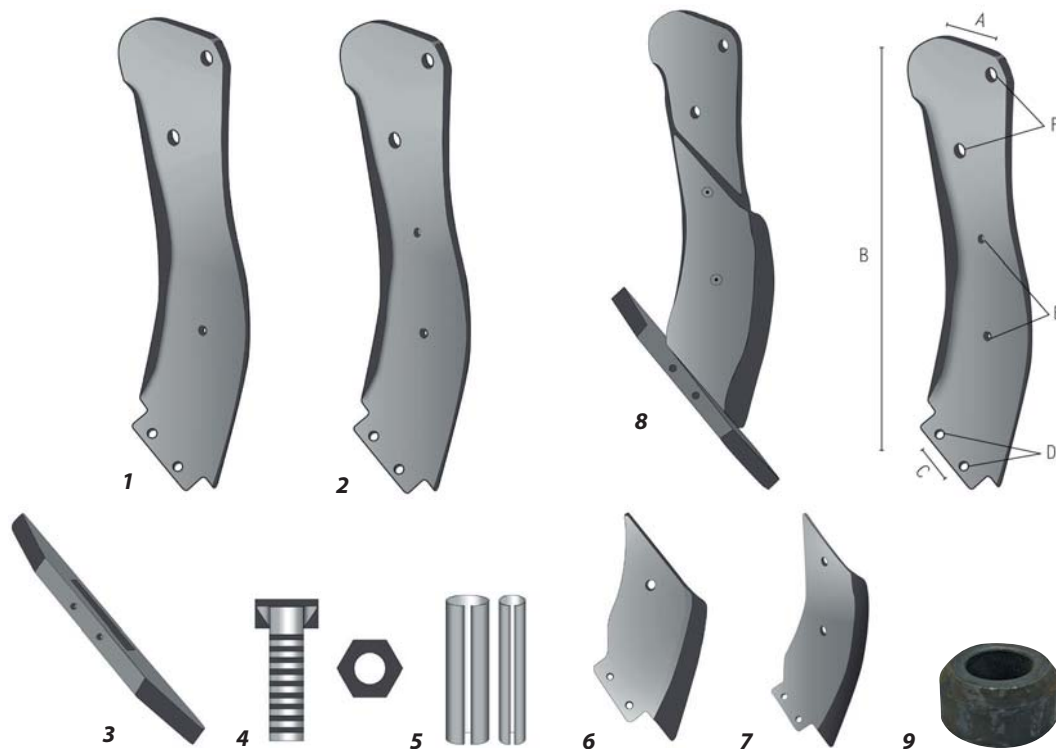

编号 Ref.	产品描述 Description	A mm	B mm	C mm	D mm	E mm	F mm	厚度Thickness mm	参考号 Ref.	重量Weight Kg
CP6057C	深松铲总成 (短护板) 右 SUBSOILER LEG ASSEMBLY RH (SMALL COUNTER-BLADE)	-	-	-	-	-	-	-	8	-
CP6058C	深松铲总成 (短护板) 左 SUBSOILER LEG ASSEMBLY LH (SMALL COUNTER-BLADE)	-	-	-	-	-	-	-	8	-
CP6059C	深松铲总成 (长护板) 右 SUBSOILER LEG ASSEMBLY RH (BIG COUNTER-BLADE)	-	-	-	-	-	-	-	8	-
CP6060C	深松铲总成 (长护板) 左 SUBSOILER LEG ASSEMBLY LH (BIG COUNTER-BLADE)	-	-	-	-	-	-	-	8	-
CP6057	铲臂 (短护板) 右 SUBSOILER BLADE RH (SMALL COUNTER-BLADE)	300	820	80	16		30	15 mm	1	23,20
CP6058	铲臂 (短护板) 左 SUBSOILER BLADE LH (SMALL COUNTER-BLADE)	300	820	80	16		30	15 mm	1	23,20
CP6059	铲臂 (长护板) 右 SUBSOILER BLADE RH (BIG COUNTER-BLADE)	300	820	80	16	14	30	15 mm	2	23,20
CP6060	铲臂 (长护板) 左 SUBSOILER BLADE LH (BIG COUNTER-BLADE)	300	820	80	16	14	30	15 mm	2	23,20
CP6061	短护板 右 SMALL COUNTER-BLADE RH (for CP6057)	-	-	-	-	-	-	8 mm	6	5,05
CP6062	短护板 左 SMALL COUNTER-BLADE LH (CP6058)	-	-	-	-	-	-	8 mm	6	5,05
CP6063	长护板 右 BIG COUNTER-BLADE RH (for CP6059)	-	-	-	-	-	-	8 mm	7	7,83
CP6064	长护板 左 BIG COUNTER-BLADE LH (for CP6060)	-	-	-	-	-	-	8 mm	7	7,83
CP6028	翻转式铲尖REVERSIBLE POINT	-	-	-	-	-	-	60x40	3	-
RC0840A	螺栓 BOLT 14X40 W/ 1 NOSE	-	-	-	-	-	-	-	4	-
CP2127	弹簧销 ELASTIC PIN 10X60	-	-	-	-	-	-	-	5	-
CP2128	弹簧销 ELASTIC PIN 16X60	-	-	-	-	-	-	-	5	-
RC0631	BOCCOLA PER ANCORA 16X30X15 MM	-	-	-	-	-	-	-	9	-

深松铲/SUBSOILER BLADES

小型深松铲
SUBSOILER LEG CURVED

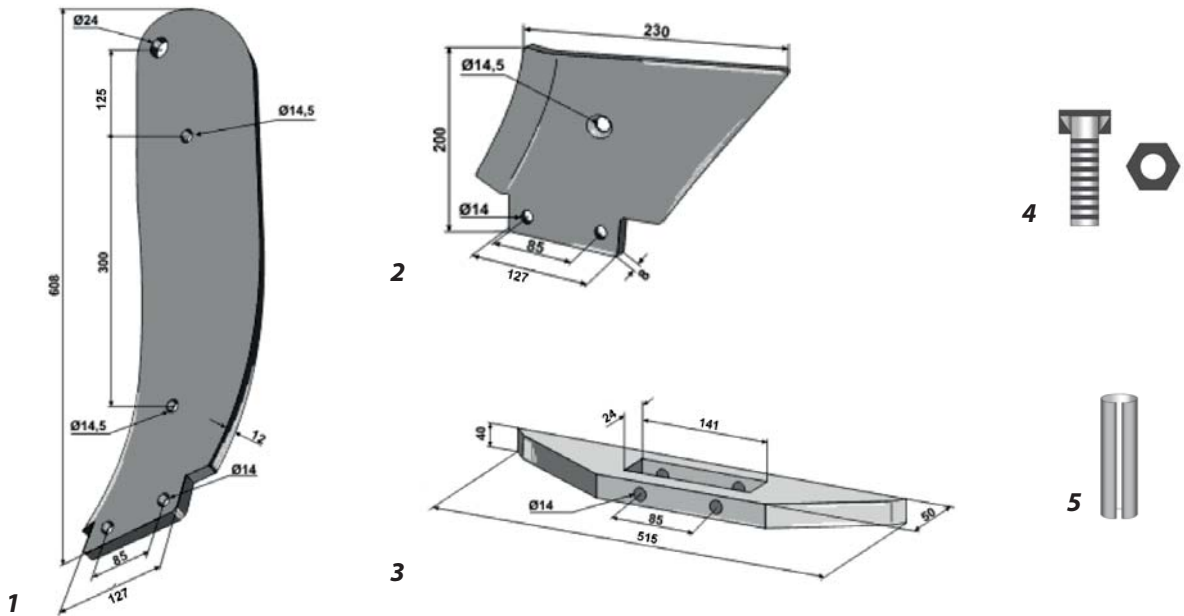

编号 Ref.	产品描述 Description	参考号Ref.
CP6112C	深松铲总成 右 SUBSOILER LEG ASSEMBLY RH	-
CP6113C	深松铲总成 左 SUBSOILER LEG ASSEMBLY LH	-
CP6112	铲臂 右 SUBSOILER BLADE RH	1
CP6113	铲臂 左 SUBSOILER BLADE LH	1
CP6114	护板 右 COUNTER-BLADE RH	2
CP6115	护板 左 COUNTER-BLADE LH	2
CP6116	翻转式铲尖 REVERSIBLE POINT	3
RC0815	六角沉头螺栓 BOLT-COUNTERSUNK HEXG HEAD 14X40	4
CP2129	弹簧销 ELASTIC PIN 14X50	5

犁体部件/PLOUGHBODY PARTS

土壤耕作易损部件:

- 优质硼钢材料制作
- 高质量, 配套广泛
- 适用于高强度作业
- 高硬度、高耐磨性

Wearing parts for soil treatment:

- Boron steel
- Top quality for all brands
- for extremely high loads
- hard and wear-resistant

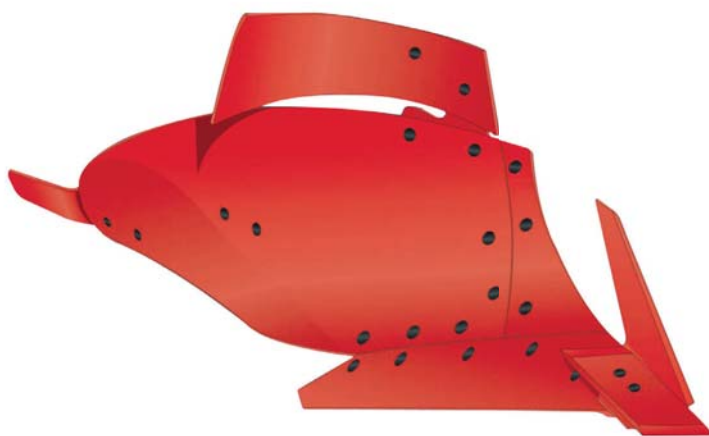

配套品牌:

- DOWDESWELL
- GHERARDI
- KUHN (库恩)
- LEMKEN (雷肯)
- OTMA
- RABEWERK (拉贝)
- REGENT
- VIVIANI

- ER.MO
- GREGOIRE-BESSON (贝松)
- KVERNELAND (格兰)
- NARDI (纳迪)
- OVERUM
- RANSOMES
- SOGEMA
- VOGEL&NOOT (维诺)



犁体部件/PLOUGHBODY PARTS

犁壁、犁翼 - 雷肯 B-C40

B-C40 MOLDBOARD, AILERONS AND FITTINGS LEMKEN

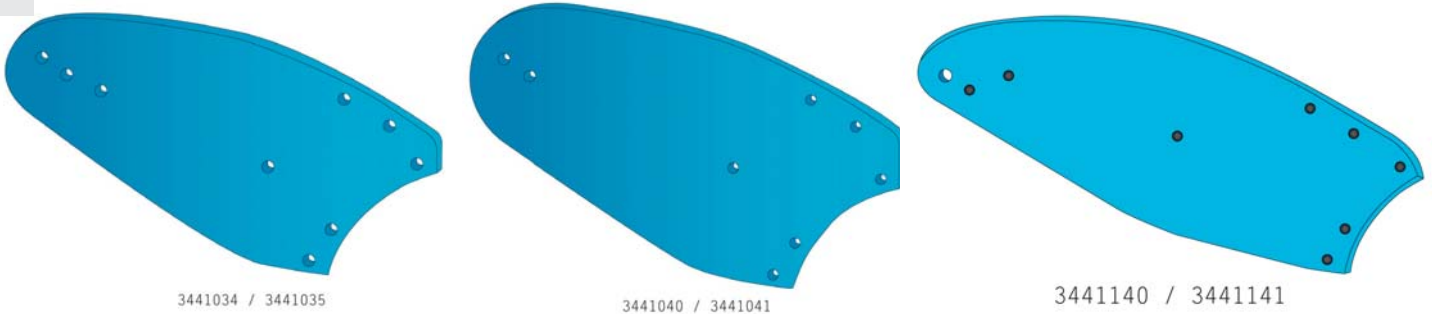

3441034 / 3441035

3441040 / 3441041

3441140 / 3441141

编号 Ref.	产品描述 Description	原厂号 Orig. ref.
RC1333	右犁翼 AILERON RH	3476000
RC1334	左犁翼 AILERON LH	3476001
RC1335	右犁壁 MOULDBOARD RH	3441034
RC1336	左犁壁 MOULDBOARD LH	3441035
RC1337	右犁壁 MOULDBOARD RH	3441040
RC1338	左犁壁 MOULDBOARD LH	3441041
CP5978	右犁壁 MOULDBOARD RH	3441140
CP5979	左犁壁 MOULDBOARD LH	3441141
RC1339	右前犁壁 PREMOULDBOARD RH	3451000
RC1340	左前犁壁 PREMOULDBOARD LH	3451001
CP5980	右前犁壁 PREMOULDBOARD RH	3451004
CP5981	左前犁壁 PREMOULDBOARD LH	3451005

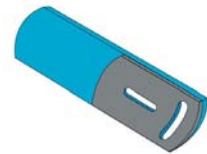

3476000 / 3476001



3451000 / 3451001



3451004 / 3451005

栅条式犁壁 - 雷肯 BS 42

LEMKEN BS 42 MOLDBOARDS, AILERONS AND FITTINGS

3444030 / 3444031

3444020 / 3444021

3444012 / 3444013

编号 Ref.	产品描述 Description	原厂号 Orig. ref.
RC1341	前犁壁 右 PREMOULDBOARD RH 10 mm	3451002
RC1342	前犁壁 左 PREMOULDBOARD LH 10 mm	3451003
RC1375A	上栅条 右 2SN STRIP RH	3444012
RC1376A	上栅条 左 2SN STRIP LH	3444013
RC1367	上中栅条 右 2SN STRIP RH	3444020
RC1368	上中栅条 左 2SN STRIP LH	3444021
RC1369	下中栅条 右 3RD STRIP RH	3444030
RC1370	下中栅条 左 3RD STRIP LH	3444031
RC1373	下栅条 右 4ST STRIP RH	3444042
RC1374	下栅条 左 4ST STRIP LH	3444043
RC1345	犁体总成本 右	4671002

3444042 / 3444043

3451002 / 3451003

犁铲、犁尖 - 雷肯 B-BS40-BS42-C-US35-US40
B-BS40-BS42-C-US35-US40 SHARES AND DRILLS LEMKEN



3365540 / 3365541

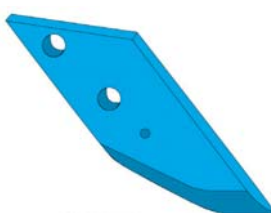

3364050 / 3364051

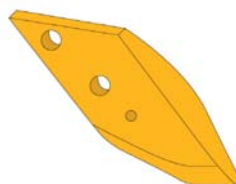

3364150 / 3364151

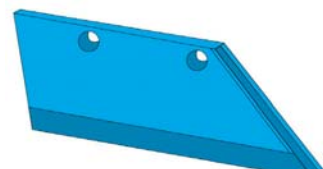

3352010 / 3352011

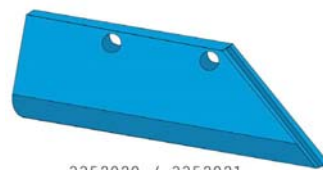

3352020 / 3352021



3352030 / 3352031



3352034 / 3352035



3352130 / 3352131

编号Ref.	产品描述 Description	厚度 Thickness mm	原厂号 Orig. ref.
RC1347	双头式犁尖 右 REVERSIBLE POINT RH	-	3365540
RC1348	双头式犁尖 左 REVERSIBLE POINT LH	-	3365541
RC1349	右犁尖 POINT RH	12 mm	3364050
RC1350	左犁尖 POINT LH	12 mm	3364051
RC1351	右犁尖 POINT RH	15 mm	3364150
RC1352	左犁尖 POINT LH	15 mm	3364151
RC1353	右犁铲 SHARE 14" RH	-	3352010
RC1354	左犁铲 SHARE 14" LH	-	3352011
RC1355	右犁铲 SHARE 16" RH	-	3352020
RC1356	左犁铲 SHARE 16" LH	-	3352021
RC1357	右犁铲 SHARE 18" RH	-	3352030
RC1358	左犁铲 SHARE 18" LH	-	3352031
RC1361	右犁铲 SHARE 18" RH 11 mm	-	3352130
RC1362	左犁铲 SHARE 18" LH 11 mm	-	3352131
RC1359	右犁铲 SHARE 20" RH	-	3352034
RC1360	左犁铲 SHARE 20" LH	-	3352035
RC1363	右犁铲 SHARE 20" RH 11 mm	-	3352134
RC1364	左犁铲 SHARE 20" LH 11 mm	-	3352135

犁侧板、犁侧刀 - 雷肯 B-BS40-BS42-C-US35-US40
B-BS40-BS42-C-US35-US40 LANDSIDES AND COULTERS LEMKEN

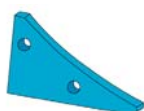

3401900AK10
3401901AK10

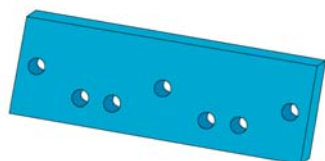

3411500

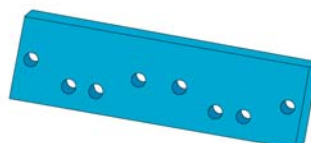

3411504

编号 Ref.	产品描述 Description	原厂号 Orig. ref.
RC1387	右犁侧板 LANDSIDE RH	3401900AK10
RC1388	左犁侧板 LANDSIDE LH	3401901AK10
RC1389	犁侧板 LANDSIDE RH/LH	3411500
RC1390	犁侧板 LANDSIDE RH/LH	3411504
RC1391	犁侧板 LANDSIDE RH/LH	3411508
RC1393	右犁侧刀 COULTER RH	3492890
RC1394	左犁侧刀 COULTER LH	3492891

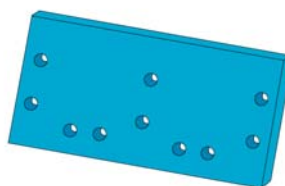

3411508



3492890
3492891

犁体部件/PLOUGHBODY PARTS

犁壁 - 库恩

MOULDBOARD FOR KUHN PARTS



619128 / 619129 / 619168 /



619200 / 619201

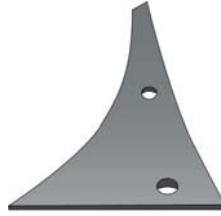

619106 / 619107

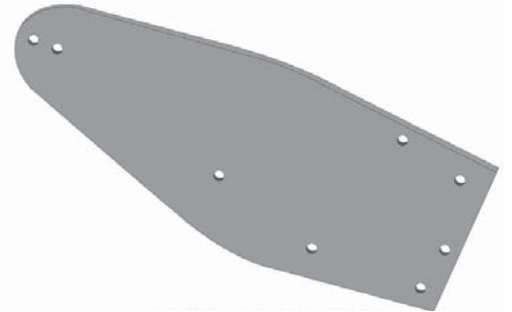

612128 / 612129 / 612108 / 612109 /
612110 / 612111 / 616138 / 616139

619169 / 619172 / 619173

编号 Ref.	产品描述 Description	厚度 Thickness mm	原厂号 Orig. ref.
RC1528	右犁壁 MOULDBOARD RH	-	612128
RC1529	左犁壁 MOULDBOARD LH	-	612129
RC1655	右犁壁 MOULDBOARD RH	-	612108
RC1655S	左犁壁 MOULDBOARD LH	-	612109
RC1655A	右犁壁 MOULDBOARD RH	-	612110
RC1655AS	左犁壁 MOULDBOARD LH	-	612111
RC1725	右犁壁 MOULDBOARD RH	8 mm	616138
RC1726	左犁壁 MOULDBOARD LH	8 mm	616139
RC1835	右犁壁 MOULDBOARD RH	7 mm	616190
RC1836	左犁壁 MOULDBOARD LH	7 mm	616191
RC1831	右犁壁 MOULDBOARD RH	7 mm	616100
RC1832	左犁壁 MOULDBOARD LH	7 mm	616101
RC1655B	右前犁壁 PREMOULD BOARD RH	-	619128
RC1655BS	左前犁壁 PREMOULD BOARD LH	-	619129
RC1526	右前犁壁 PREMOULD BOARD RH	-	619168
RC1527	左前犁壁 PREMOULD BOARD LH	-	619169
RC1530	右前犁壁 PREMOULD BOARD RH	8 mm	619172
RC1531	左前犁壁 PREMOULD BOARD LH	8 mm	619173
RC1727	右前犁壁 PREMOULD BOARD RH	7 mm	619200
RC1728	左前犁壁 PREMOULD BOARD LH	7 mm	619201
RC1833	右前犁壁 PREMOULD BOARD RH	7 mm	619106
RC1834	左前犁壁 PREMOULD BOARD LH	7 mm	619107

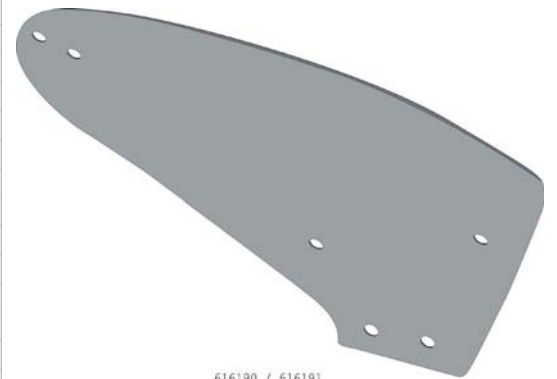

616190 / 616191



616100 / 616101

犁尖 - 库恩

POINT FOR KUHN PARTS



622128
622129



622174
622175



622180
622181

编号 Ref.	产品描述 Description	厚度 Thickness mm	重量 Weight Kg	说明 Notes	原厂号 Orig. ref.
RC1532	双头式犁尖 右 REVERSIBLE POINT RH	15 mm	2,5	宽W/ 75 mm . 长L/ 283 mm. 两孔 2 HOLES	622128
RC1533	双头式犁尖 左 REVERSIBLE POINT LH	15 mm	2,5	宽W/ 75 mm . 长L/ 283 mm. 两孔 2 HOLES	622129
RC1532A	双头式犁尖 右 REVERSIBLE POINT RH	15 mm	2,5	宽W/ 80 mm. 长L/ 293 mm. 两孔 2 HOLES	622174
RC1533A	双头式犁尖 左 REVERSIBLE POINT LH	15 mm	2,5	宽W/ 80 mm. 长L/ 293 mm. 两孔 2 HOLES	622175
RC1532B	双头式犁尖 右 REVERSIBLE POINT RH	12 mm	2	宽W/ 75 mm . 长L/ 283 mm. 两孔 2 HOLES	622180
RC1533B	双头式犁尖 左 REVERSIBLE POINT LH	12 mm	2	宽W/ 75 mm . 长L/ 283 mm. 两孔 2 HOLES	622181

犁铲 - 库恩

SHARE FOR KUHN BODIES

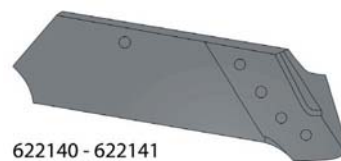
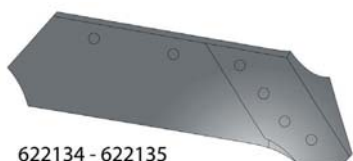

编号 Ref.	产品描述 Description	原厂号 Orig. ref.
RC1680	右犁铲 SHARE RH	622134
RC1681	左犁铲 SHARE LH	622135
RC1682	右犁铲 SHARE RH	622136
RC1683	左犁铲 SHARE LH	622137
RC1684	右犁铲 SHARE RH	622140
RC1685	左犁铲 SHARE LH	622141
RC1686	右犁铲 SHARE RH	622142
RC1687	左犁铲 SHARE LH	622143
RC1688	右犁铲 SHARE RH	622166
RC1689	左犁铲 SHARE LH	622167
RC1690	右犁铲 SHARE RH	622172
RC1691	左犁铲 SHARE LH	622173



犁侧板、犁侧刀 - 库恩

LANDSIDES AND COULTERS FOR KUHN BODIES

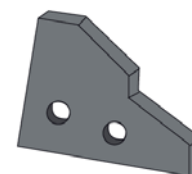
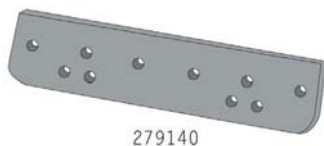

编号 Ref.	产品描述 Description	厚度 Thickness mm	原厂号 Orig. ref.
RC1710	犁侧板 LANDSIDE RH/LH	10 mm	223192 761108
RC1711	犁侧板 LANDSIDE RH/LH	10 mm	279140
RC1712	右犁侧板 LANDSIDE RH	10 mm	279114
RC1713	左犁侧板 LANDSIDE LH	10 mm	279115
RC1714	右犁侧板 LANDSIDE RH	10 mm	279130
RC1715	左犁侧板 LANDSIDE LH	10 mm	279131
RC1716	犁侧板 LANDSIDE RH/LH	10 mm	200645
RC1717	右犁侧板 LANDSIDE RH	10 mm	278076
RC1718	左犁侧板 LANDSIDE LH	10 mm	278077
RC1719	右犁侧板 LANDSIDE RH	10 mm	278074
RC1720	左犁侧板 LANDSIDE LH	10 mm	278075
RC1721	右犁侧板 LANDSIDE RH	10 mm	279138
RC1722	左犁侧板 LANDSIDE LH	10 mm	279139
RC1723	右犁侧板 LANDSIDE RH	10 mm	761110
RC1724	左犁侧板 LANDSIDE LH	10 mm	761111
RC1729	犁侧刀 COULTER	10 mm	270060

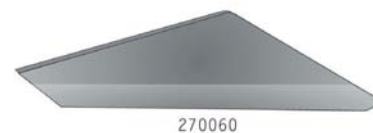

犁体部件/PLOUGHBODY PARTS

犁壁、犁翼、覆土板 - 格兰

MOLDBOARDS, AILERONS AND FITTINGS KVERNELAND



073300 / 073301



073310 / 073311

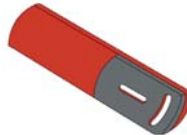

053387 / 063388



073411 / 073412

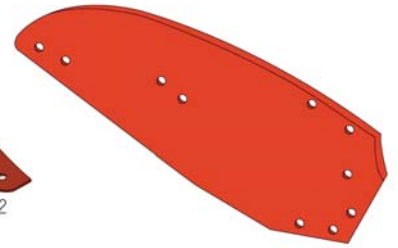

063283 / 063293



063240 / 063250



073250 / 073251



073256 / 07325

073230 / 073231

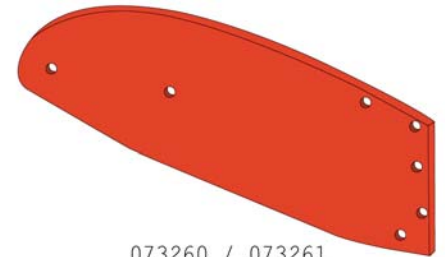

073260 / 073261
073280 / 073281

编号Ref.	产品描述Description	原厂号Orig. ref.
RC1005	右覆土板 UP MOULDBOARD RH	073300
RC1005S	左覆土板 UP MOULDBOARD LH	073301
RC1006	右覆土板连接件 UP MOULDBOARD FITTING RH	073310
RC1006S	左覆土板连接件 UP MOULDBOARD FITTING LH	073311
RC1016	右犁翼 AILERON RH	053387
RC1016S	左犁翼 AILERON LH	063388
RC0989	右犁壁 MOULDBOARD 14"/16" RH	063283
RC0989S	左犁壁 MOULDBOARD 14"/16" LH	063293
RC1009	右犁壁 MOULDBOARD 12"/16" RH	073260
RC1009S	左犁壁 MOULDBOARD 12"/16" LH	073261
RC1011	右犁壁 MOULDBOARD 12" RH	073280
RC1011S	左犁壁 MOULDBOARD 12" LH	073281
RC1012	右犁壁 MOULDBOARD 12"/18" RH	073286
RC1012S	左犁壁 MOULDBOARD 12"/18" LH	073287
RC1013	右犁壁 MOULDBOARD 14"/20" LH	073290
RC1013S	左犁壁 MOULDBOARD 14"/20" LH	073291
RC1049	右犁壁 MOULDBOARD RH	083228
RC1049S	左犁壁 MOULDBOARD LH	083229
RC0990	右前犁壁 PREMOULDBOARD RH	063240
RC0990S	左前犁壁 PREMOULDBOARD LH	063250
RC1014	右前犁壁 PREMOULDBOARD RH	073250
RC1014S	左前犁壁 PREMOULDBOARD LH	073251
RC1015	右前犁壁 PREMOULDBOARD RH	073256
RC1015S	左前犁壁 PREMOULDBOARD LH	073257
RC1029	右前犁壁 PREMOULDBOARD 8 mm RH	073230
RC1029S	左前犁壁 PREMOULDBOARD 8 mm LH	073231
RC1029I	右前犁壁 PREMOULDBOARD 10 mm RH	073230
RC1029IS	左前犁壁 PREMOULDBOARD 10 mm LH	073231
RC1039	右犁托BASE RH	073411
RC1039S	左犁托 BASE LH	073412

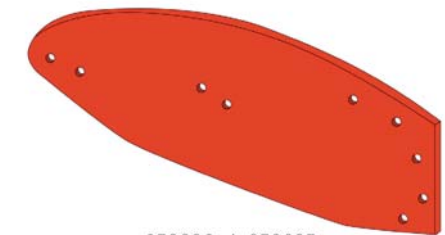

073286 / 073287

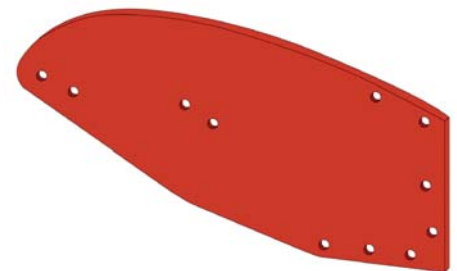

073290 / 073291

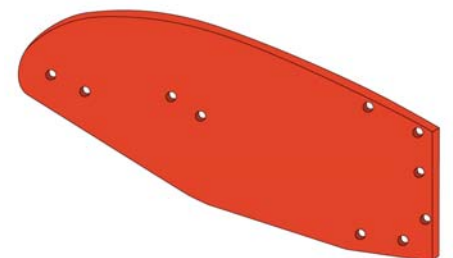

083228 / 083229

犁铲 - 格兰

PLOUGHSHARES KVERNELAND

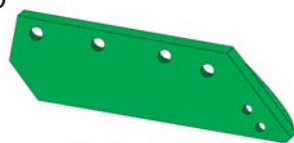

063016 / 063013

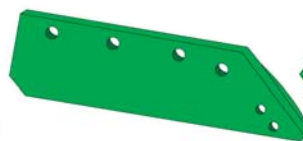

063014 / 063017



063015 / 063018

编号Ref.	产品描述Description	原厂号Orig. ref.
RC0980	右犁铲 SHARE RH	063013
RC0980S	左犁铲 SHARE LH	063016
RC0981	右犁铲 SHARE 14" RH	063014
RC0981S	左犁铲 SHARE 14" LH	063017
RC0982	右犁铲 SHARE 16" RH	063015
RC0982S	左犁铲 SHARE 16" LH	063018
RC1000	右犁铲 SHARE 12" RH	073000
RC1000S	左犁铲 SHARE 12" LH	073001
RC1001	右犁铲 SHARE 14" RH	073002
RC1001S	左犁铲 SHARE 14" LH	073003
RC1002	右犁铲 SHARE 16" RH	073004
RC1002S	左犁铲 SHARE 16" LH	073005
RC1003	右犁铲 SHARE 18" RH	073006
RC1003S	左犁铲 SHARE 18" LH	073007
RC1004	右犁铲 SHARE 20" RH	073008
RC1004S	左犁铲 SHARE 20" LH	073009
RC1022	右犁铲 SHARE RH	073056
RC1022S	左犁铲 SHARE LH	073057
RC1023	右犁铲 SHARE RH	073080
RC1023S	左犁铲 SHARE LH	073081

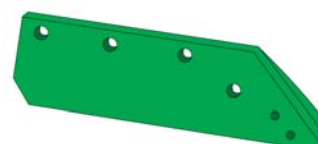

073000 / 073001
073002 / 073002

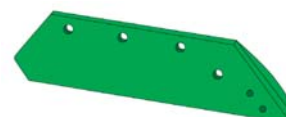

073004 / 073005



073006 / 073007

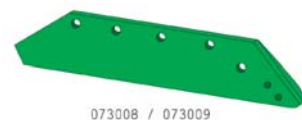

073008 / 073009



073056
073057



073080
073081

犁尖、犁刀、侧板 - 格兰

POINTS, COULTERS AND LANDSIDES KVERNELAND

编号Ref.	产品描述Description	原厂号Orig. ref.
RC0983	双头式犁尖 右 REVERSIBLE POINT RH 12mm	053090
RC0983S	双头式犁尖 左 REVERSIBLE POINT LH 12mm	063090
RC0983RP	双头式犁尖 (焊接式) 右 REVERSIBLE POINT RH 12mm WELDING	053090
RC0983SRP	双头式犁尖 (焊接式) 左 REVERSIBLE POINT LH 12mm WELDING	063090
RC0983SP15	双头式犁尖 右 REVERSIBLE POINT RH 15mm	053090
RC0983SSP15	双头式犁尖 左 REVERSIBLE POINT LH 15mm	063090
RC0984	右犁刀 COULTER RH	073091
RC0984S	左犁刀 COULTER LH	073092
RC0985	右犁侧板 LANDSIDE RH	063603 / 063613
RC0985S	左犁侧板 LANDSIDE LH	063604
RC0986	短款右犁侧板 SHORT LANDSIDE RH	063605 / 063615
RC0986S	短款左犁侧板 SHORT LANDSIDE LH	063606
RC1007	犁侧板 LANDSIDE RH/LH	073608
RC1008	犁侧板 LANDSIDE RH/LH	073609
RC1017	短款犁侧板 SHORT LANDSIDE RH/LH	073600
RC1019	短款犁侧板 SHORT LANDSIDE RH/LH	073610
RC1020	长款犁侧板 LONG LANDSIDE RH/LH	073604
RC1021	长款犁侧板 LONG LANDSIDE RH/LH	073612



053090 / 063090



073091 - 073092



063613 / 063604 / 063603

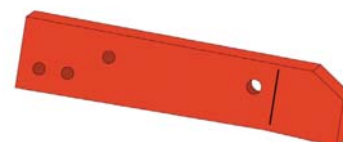

063615 / 063606 / 063605

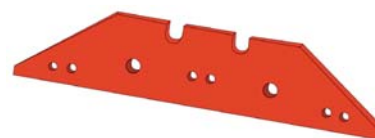

073609 / 073612 / 073604



073608 / 073600 / 073610



埃马（上海）商贸有限公司

AMA (Shanghai) Trading Co., Ltd.

地址：上海市陕西北路1438号财富时代大厦2019室

电话：+86 21 5178 0125 / 158 2140 8879

传真：+86 21 51780126

网站：www.ama.it www.ama-shanghai.com

电邮：ama-shanghai@ama.it daniel.wang@ama.it